

Poly Crystalline Solar Module

ESP 340/345/350/355/360



KEY FEATURES



Excellent module efficiency up to:17.52%



IP68 junction box for long-term weather endurance



Heavy snow loading up to 5400 Pa, wind loading up to 2400 Pa



PID: selected material and stringent quality system ensure PID free



Applicable to harsh environment of deserts, farmlands and seashores



Much lower risk of Hot Spot

CERTIFICATE



WARRANTY



Linear power output warranty
-12 years minimum 92% power output
-30 years minimum 83% power output



Product warranty on materials and workmanship
According to the applicable Einnova Solarline Limited Warranty Statement

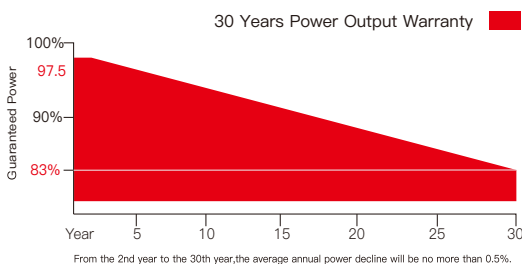

Einnova Solarline

invented for solar

DIMENSIONS OF PV MODULE (unit:mm)

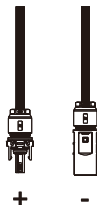
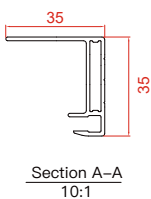
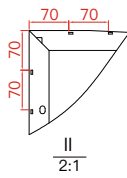
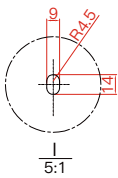
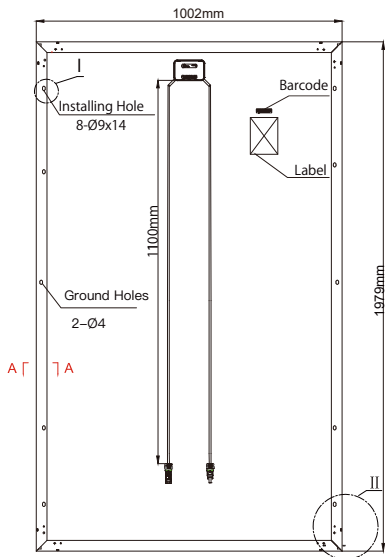
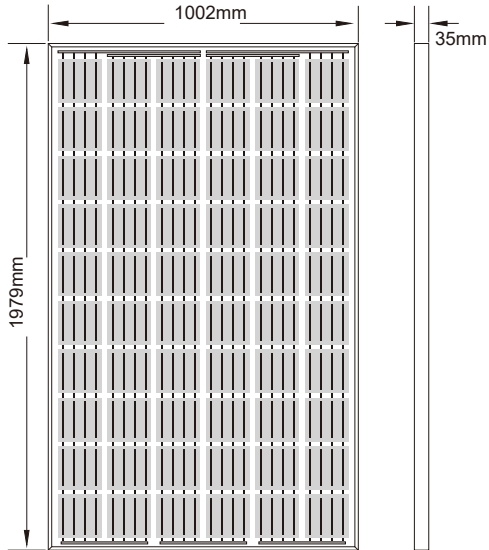

I-V Curve at Different Temperature

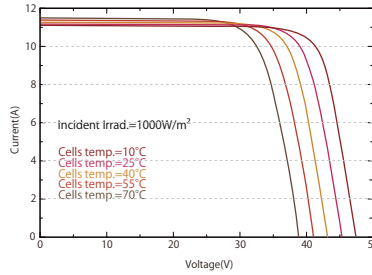

I-V/P-V Curve at Different Irradiation

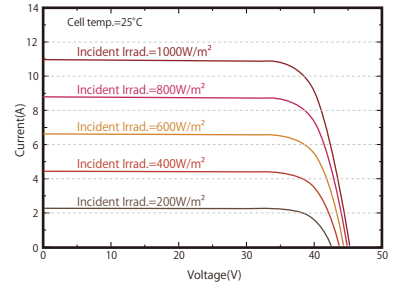

ELECTRICAL DATA@STC	ESP-340	ESP-345	ESP-350	ESP-355	ESP-360
Pmax(with tolerance) [W]	340	345	350	355	360
Module Efficiency- η_m (%)	17.52	17.78	18.04	18.30	18.56
IOpen Circuit Voltage (Voc)	46.30	46.40	46.50	46.70	46.80
Short Circuit Current (Isc)	9.41	9.46	9.51	9.56	9.61
IMaximum Power Voltage (Vmp)	37.80	37.90	38.00	38.10	38.20
Maximum Power Current (Imp)	9.00	9.10	9.21	9.31	9.42
Maximum System Voltage	ICE 1500VDC				
STC:Irradiance:100W/m ² ,Module Temperature:25°C,Air Mass:1.5					

ELECTRICAL DATA@NOCT	ESP-340	ESP-345	ESP-350	ESP-355	ESP-360
Pmax[W]	265.87	269.10	273.30	276.90	280.80
Vmp [V]	35.23	35.33	35.43	35.53	35.63
Imp [A]	7.55	7.61	7.71	7.79	7.88
Voc[V]	43.38	43.48	43.58	43.68	43.78
Isc[A]	7.61	7.66	7.71	7.76	7.81
NOCT:Irradiance:800W/m ² , Ambient Temperature:20°C,Air Mass:1.5,Wind Speed:1m/s					

MECHANICAL SPECIFICATIONS

Solar Cell Type	Poly Crystalline
Number of Cells	72pcs (12*6)
Module Size	1979*1002*35mm
Weight	21kg
Glass	3.2mm tempered glass
Back Sheet	White or Black
Frame	Anodized aluminium alloy,silver or black
Junction Box	IP68
Quantity of Diodes	3pcs
Cable	4.0mm ² 1100mm
Connector	MC4 Compatible
Wind/Snow Load	2400pa/5400pa

TEMPERATURE CHARACTERISTIC

NMOT (Nominal Module Operating Temperature)	45°C (±2°C)
Temperature Coefficient of Pmax	- 0.41%/°C
Temperature Coefficient of Uoc	- 0.32%/°C
Temperature Coefficient of Isc	0.05%/°C

PACKAGING CONFIGURATION

Modules per box:	30 pieces
Number per 20GP:	300 pieces
Modules per 40' HQ:	715 pieces

MAXIMUM RATINGS

Operational Temperature	-40 to +85°C
Maximum System Voltage	1500V DC(IEC)
Max Series Fuse Rating	20A
Protection Class	Class II
Snow Loading	5400 Pa
Wind Loading	2400 Pa
Hailstone Test	25mm Hailstone at the speed of 23m/s

*design load with safety factor 1.5
(DO NOT connect Fuse in Combiner Box with two or more strings in parallel connection)